

# Tiger DRX-P Podiatry

Acquire | Store | View | Share

## Premium Gadox 12x12 & 14x17 Flat Panel Detector System



### The Industry Leading DR and Podiatry PACS Solution

Tiger DRX-P is the only true DR Premium GADOX Panel X-Ray detector solution for the podiatry market. Using Premium GADOX technology provides superior image quality. Tiger DRX-P allows podiatrists the logical and modern solution when converting to Digital X-Ray or upgrading from older technology.

Tiger DRX-P comes with a handled detector encasement that is designed for increased maneuverability and durability. Our specialized encasement has been designed to fit exclusively into our ADA conformant orthoposer. At 3.5" tall, it's simple to position patients using X-Cel's exclusive tilt-head, bi-directional functionality.

TigerView is a Podiatry Specific PACS software that understands the needs of the practitioner and has been developed with 30+ different podiatry measurements. Comprehensive AP and Lateral tool sets provide for quick and efficient patient diagnosis. Reward yourself with the newest and most logical workflow designed to simplify the experience and enhance the interaction as you look at superior image quality.

Tigerview offers complete turn-key solutions. Available upgrades to the DRX-P solution: Wireless panel, TigerView CLOUD, TigerView Mobile, TigerView Portal and TigerView back-up.

Standard Tigerview X-Cel packages include:

- 23" computer
- X-Cel bi-directional x-ray generator
- X-Cel ADA compliant ortho-base
- X-Cel ergonomic panel encasement
- TigerView Podiatry PACS software
- Five viewing software licenses
- Bridges to EMR, EHS & PMS
- On-site install and training



4.5 lbs for 12x12, 6 lbs for 14x17



Panel available tethered or wireless



6 second image acquisition time



Directly integrates with TigerView software



No cassettes necessary



2 year x-ray and 3 year panel warranty



X-Cel bi-directional tilt-head x-ray included

Call us for an in-office demo today.

**1-800-385-9593**

# Tiger DRX-P Podiatry

## Premium Gadox 12x12 & 14x17 Flat Panel Detector System

### SPECIFICATIONS

Sensor	
Sensor	a-Si TFT Array
Conversion Screen	CsI: TI / Premium Gadox
Image Data	16 bits
Limiting Resolution	3.5 lp/mm
12x12 Active Area	12x12 (287x287mm)
14x17 Active Area	14x17 (350x430mm)
12x12 Sensor Pixel	2048x2048
14x17 Sensor Pixel	2560x3072

Image Quality	
Data Transfer Time	Less than 1 second
12x12 Internal Storage	Up to 200
14x17 Internal Storage	Up to 150

Communication Interface	
Image Acquisition Time	3-5 sec. (approx)
Trigger Mode	AED (Auto Exposure Detection), Manual Trigger
Calibration Mode	ACC (Auto Calibration Control), Manual Calibration
Image Transmission	Gigabit Wi-Fi IEEE 802.11

Environmental	
Operating	
Temperature Range	10 - 35°C
Humidity Range (non-condensing)	20% - 75% RH

Storage	
Temperature Range	-10°C - 60°C
Humidity Range	10% - 90% RH
Water / Dust Proof	IP64

Mechanical	
12x12 Dimensions	308.5x319.5x15mm
14x17 Dimensions	385x460x15mm
12x12 Weight	4.4 lbs w/battery
14x17 Weight	6 lbs w/battery

Power	
Battery Performance	10 hours
AC Power	
Power Supply	100 - 240V AC
Frequency	50/60 Hz

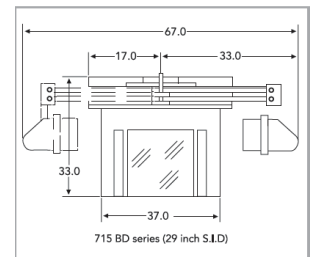

For complete product information, visit [televeresystems.com](http://televeresystems.com)